School Information

2013 - 14

TABLE OF CONTENTS

Page

1	School Information
5	School Bell Schedule
6	School Map
7	Student Dress Code
8	Bus Disclosure Statement
9	7 th Grade Orientation
10	Back to School Night
11	iFlight
13	Teacher Advisory/Student-Led Conferences
14	Safe Walking Routes
17	Immunization Requirements for 7 th Grade



School Information 2013-14

ONLINE ENROLLMENT

For your convenience registration will be online through Skyward Family Access. Online Enrollment will be available from Monday, July 29th, 2013 to Friday, August 9th, 2013. Using your **PARENT LOGIN**, login to Skyward Family Access, select your Sunset Ridge Middle School student and click the Online Registration link titled "Register for 2013-2014". You must sign into Skyward Parent Access using the "**PARENT**" login. You will have the option of paying fees online including lunches.

After online registration is complete students/parents may log onto Skyward through "STUDENT" Access to view their schedule, busing information and lockers on or after August 15th. Please note that if you have NOT completed the online registration process your student's information will NOT be available.

Patrons without computer access **or** who would like to have assistance to complete this process may do so on a computer at the school. A hard copy registration book is available in the main office.

REGISTRATION PROCESS:

Prepare to Register:

- Determine what method of payment you will use.
 - o Online payment: Discover, Master Card, or Visa
 - o Physical payment: Cash, check, or fee waiver (only with the approved form – information is found below) Be sure to include your students name with all physical payments. *Your payment may be mailed or brought into the main office and is required before your student is considered "Registered".*
- Have your Family Access parent log-in name and password ready (not the student long-in and password). Your log-in name and password were mailed to your previously. If you have forgotten or cannot locate your log-in information and password please contact the main office at SRMS at 801.412.2475 and we will help you.

How to Register:

1. Go to www.jordandistrict.org
2. Under the "Parents and Students" drop-down menu, click "Family Access (Skyward)"
3. Select "Start Registration for _____"
 - a. You will need to complete ALL steps before your student is registered.
 - b. Once you have filled everything out you will only have to update your information each time you register your student.
 - c. You will be able to pay for registration and lunches.
 - d. By following the PTSA link you will be taken to an external web page to pay for PTSA membership, memory books and PTSA clothing.

After you Register:

Your students schedule, locker information, and bus information (if applicable) will be available beginning August 15th.

FEES

- 7TH Grade \$85
- 8th & 9th Grade \$65
- If you do not pay fees online checks must be written for the exact amount only and made payable to Sunset Ridge Middle School. Please include your students name and grade on the check. Returned checks go directly to Express Recovery for payment.
- P.E. clothes can be paid with registration. (optional)

FEE WAIVER

- Fee waiver and free/reduced lunch forms are available online during the online enrolment process.
- **Students applying for fee waivers will need to call 801.412.2475 after August 6th to set up an appointment to review the form with your students Assistant Principal. This is a law established by the State Legislature.**
- In order to be considered for registration fee waiver, both the "Fee Waiver" form and an "Application for Free and Reduced Lunch" must be completed. Please give permission on the "Application for Free and Reduced Lunch" to share information with the school administration. **Only those students who qualify for free lunch are eligible for fee waivers.**

SCHOOL LUNCH & BREAKFAST

- Lunch prices are \$2.00/day with al-a-carte available. A second lunch purchased the same day is \$3. Breakfast is \$1/day from 7:15 to 7:45 Monday-Thursday & Fridays 9:15-9:45.
- Deposits may be returned with the registration materials into the main office if not paying online. *No checks will be cashed or change given for vending machines.* Lunch money may be deposited online using Skyward.
- Sunset Ridge Middle School is a closed campus. Students will be considered truant if off school grounds during lunch.
- **Students will not be allowed to debit their lunch account.**
- Students who do not have money in their lunch account will be offered a roll and milk.

STATEMENT REGARDING FREE AND REDUCED LUNCH

- You may apply for free/reduced lunch during the online registration process.

FIRST DAY OF SCHOOL FOR 7TH GRADE STUDENTS

- Seventh grade students will attend a half day on **Monday, August 22nd, 2013**. Buses will run their normal routes. This day is for 7th grade students only and is a school day for these students.

7TH GRADE WALK-A-BOUNTS

- The school will be open Thursday August 15th from 9:30am to 12:30pm for 7th grade students and an adult to come and familiarize themselves with Sunset Ridge.

IMMUNIZATION CARE-A-VAN

- For your convenience we have arranged for the Immunization Care-A-Van to be at Sunset Ridge on **August 15th, 2013 from 9:30am to 11:30am.**

IMMUNIZATIONS

- All 8th and 9th grade students must have (5) DPT, (4) Polio, (2) MMR, (3) Hepatitis, (2) Hepatitis A, and Varicella (chickenpox) – history of disease is acceptable, before registering. **7th grade students need an additional TDAP booster. Proof of immunizations for 7th grade is required with the registration materials.**
- **State Statute states that 7th grade students who DO NOT receive their TDAP by the first day of school WILL NOT be able to attend.**
- Students who attended school at Sunset Ridge last year will have immunization records on file.
- Students who are not immunized for medical or personal reasons are required to obtain an exemption form from the local health department which must be presented with registration. A new exemption form must be completed every year.

FIRST DAY OF SCHOOL FOR 8TH AND 9TH GRADE STUDENTS

- The 2013-14 school year will begin on **Monday, August 26th, 2013.**
- School will start at 7:50am and dismiss at 2:50pm Monday through Thursday. Friday start time is at 9:50 and dismisses at 2:50pm.

BACK TO SCHOOL NIGHT

- **Wednesday, August 29th 2013 from 4-6pm**

- This is an opportunity for you to meet your student's teachers for an overview of their class.

CLASS SCHEDULES

- Class schedules are available **after** registration is completed **and** fees are paid.
- Report corrections in name, address or phone number to the attendance office at 801.412.2480.
- Counselors will make class schedule changes the first week of school based on credit needs. Schedule changes to be in classes with friends or have a specific lunch are **NOT** legitimate reasons for schedule changes.

LOCKERS

- Lockers are the property of Sunset Ridge Middle School.
- For security, please instruct your student to **never** share their locker combination with others.
- Lost and stolen items are not the responsibility of Sunset Ridge Middle School.
- Seventh grade students will locate and practice their locker combinations during 7th grade orientation.

ELECTRONIC DEVICES

- To establish a safe and effective educational environment:
 - Cell phones may be used prior to instructional time at 7:50, at lunch, and after school ends at 2:50pm.
 - We encourage students to leave all iPods, MP3's, and portable gaming systems at home. Electronic devices may only be use before and after school.
 - eReaders may be used at SRMS *as directed* by your student's teachers.
- When these expectations are not followed the cell phone/electronic device will be confiscated. The first time the device is taken the student may pick it up after school. The second and subsequent times, should that occur, a parent will need to pick up the device in the attendance office.
- ***Sunset Ridge is not responsible for lost or stolen cell phones/electronic devices. We will refer the situation to our school resource officer.***

STUDENT PLANNERS

- Students will be issued a personal school planner during the first week of school.
- Students will receive a magnetic school calendar with their planner.
- Students and parents will be requested to sign a Planner Contract after reviewing the Student Code of Conduct.
- If your student loses their planner a new one may be purchased in the main office for \$5.

SKYWARD

- Student and parent login information was sent home prior to this letter. If you have lost your login information please contact the school at 801.412.2475.
- **For security purposes, when asking for login and password information over the phone, Sunset Ridge office staff will ask security questions prior to releasing any sensitive information.**

SKYLERT

- SkyLert is an automated communication tool used by the school to inform parents of attendance, important dates and events, emergencies, or other necessary information.
- SkyLert uses e-mail, phone, cell phone, and text messages. Each of these methods of communication is customizable by you through Skyward Family Access.
- To enhance our ability to communicate with you please take a moment to enter your e-mail, phone, and cell phone information.
- If you require assistance in accessing this tool please contact the attendance office at Sunset Ridge.

COMMUNICATION

- Sunset Ridge wants to keep you informed about your school. Please note the several methods we use:
 - Skyward Family Access

- SkyLert
- Sunset Ridge online <http://srms.info>
- PTSA newsletter (on the school web site and e-mailed through SkyLert)
- School newsletter sent via e-mail through Skyward/Skylert
- Various mailings and handouts

Student Support

- SRMS provides support and opportunities for students to increase learning and effectiveness in the following ways:
 - iFlight – held 2-3 days a week for students to receive help with concepts and classwork.
 - Teacher Advisory (TA) – 8th period on your students schedule. Grade checks, character education, etc... Students will receive a Pass/Fail for this class.
 - Academic Skills Academy (ASA) – for students who are identified by their teachers who need increased curricular support. This academy is during lunches and Friday mornings. ASA is referral-based.
 - Falcon's Lair – An internet Café for student use before/after school & during lunches.
 - Math Lab – before/after school Tues-Thurs.
 - One-on-one Assistance – Teachers are available before and after school for individual help.

PE Clothes

- Your student is required to have appropriate clothing for PE. This consists of a t-shirt and shorts. Preferably dark shorts and light colored shirts.
- You may choose to purchase your students PE clothes through the school. (optional)
- If you choose simply select the PE Clothing option when paying for student fees. (\$10)

PTSA

- Please locate the PTSA link found in the registration process to purchase your memory book, membership, T-shirts, etc...
- This link will take you to an external web site.

Sunset
Ridge
Middle School

Sunset Ridge Middle School Bell Schedules

Monday – Wednesday TA/iFlight Schedule			Thursday TA Block Schedule		
1 st Period	7:50 am	8:36 am	1 st Period	7:50 am	9:14 am
2 nd Period	8:41 am	9:29 am	2 nd Period	9:19 am	10:43 am
TA / iFlight	9:34 am	10:04 am	TA/iFlight	10:48 am	11:23 am
3 rd Period	10:09 am	10:55 am	A Lunch	11:23 am	11:53 am
A Lunch	10:55 am	11:25 am	3 rd Period	11:58 am	1:22 pm
4 th Period	11:30 am	12:16 pm	3 rd period	11:28 am	12:10 pm
5 th Period	12:21 pm	1:08 pm	B Lunch	12:10 pm	12:40 pm
4 th Period	11:00 am	11:46 am	3 rd Period	12:43 pm	1:22 pm
B Lunch	11:46 am	12:16 pm	3 rd Period	11:28 pm	12:52 pm
5 th Period	12:21 pm	1:08 pm	C Lunch	12:52 pm	1:22 pm
4 th Period	11:01 am	11:47 am	4 th Period	1:27 pm	2:50 pm
5 th Period	11:52 am	12:38 pm			
C Lunch	12:38 pm	1:08 pm			
6 th Period	1:13 pm	1:59 pm			
7 th Period	2:04 pm	2:50 pm			

LATE START 9:50 AM FRIDAY BLOCK SCHEDULE			THURSDAY BLOCK ASSEMBLY SCHEDULE		
5 th Period	9:50 am	11:16 am	1 ST Period	7:50 am	9:08 am
A Lunch	11:16 am	11:46 am	2 ND - Assembly	9:13 am	11:34 am
6 th Period	11:51 am	1:19 pm	A Lunch	11:34 am	12:04 pm
6 th Period	11:21 am	12:03 pm	3 rd Period	12:09 pm	1:28 pm
B Lunch	12:03 pm	12:33 pm	3rd Period	11:39 am	12:17 pm
6 th Period	12:36 pm	1:19 pm	B Lunch	12:17 pm	12:47 pm
6 th Period	11:21 am	12:49 pm	3 rd Period	12:50 pm	1:28 pm
C Lunch	12:49 pm	1:19 pm	3 rd Period	11:39 am	12:58 pm
7 th Period	1:24 pm	2:50 pm	C Lunch	12:58 pm	1:28 pm
			4 th Period	1:33 pm	2:50 pm



2013 - 2014



Sunset Ridge Middle School

Sunset Ridge Middle School

Dress Code Reminder

Dear Parent(s) or Guardian(s),

Sunset Ridge would like to remind you of the Student Dress Code as you prepare to shop for school clothes. As always, we want to thank you for your support in working with us to make the school experience a positive one for everyone. As per district policy, (AA419) a reasonable dress code is an important part of a safe and appropriate learning environment. If you have any questions or concerns, please feel free to contact a member of the administration at (801) 412-2475 and we will be happy to speak with you concerning any aspect of the dress code. Again, thank you for sending your children to our school, may we always merit your trust in educating them.

Please do not send your student to school with any of (but not limited to) the following:

- Any item that has writing, pictures, or any insignias, which are crude, vulgar, profane, violent, or sexually suggestive.
- Any item that advertises, promotes, or has any likeness of tobacco, alcohol, or drugs.
- Any hair that is conspicuous, extreme, odd or colored in such a way that it draws undue attention, disrupts, or tends to interfere with the learning environment.
- Pants with large holes or holes above mid-thigh are not appropriate for school unless leggings are worn underneath to cover any exposed skin.
- Shorts and skirts must be mid-thigh when SEATED even if leggings are worn underneath – A trick to know if they are long enough is to have your student stand with their arms to their side – if the short or skirt is longer than the tips of their fingers – it should be fine.
- Any clothing that reveals the midriff or cleavage is not appropriate.
- Halter-tops, spaghetti straps, tank shirts or similar clothing should not be worn to school. Clothing shall cover the shoulders, midriff, underwear, backs and cleavage at all times.
- Hats of any kind.
- Any item that has been identified as “gang-related” such as Psychopathic Records (Hatchet Man, ICP, KMK, etc.), Old English lettering on buckles and clothing, “rags”, bandanas, etc.

For your information:

- Students must comply with the laws that govern wearing military uniforms and insignias (Title 10 USC §771-772, and Army Regulation 670-1 §29-4).
- Shoes must be worn at all times. Slippers do not constitute shoes.
- Gang-related items are determined by policy and in consultation with law enforcement, including the Metro Gang Unit.

Thanks you for your ongoing support!

Sunset Ridge Middle School Administration

Bus Disclosure Statement

Dear Parents and Students:

There are a few responsibilities associated with the privilege of riding a bus. This letter details some of those responsibilities.

The following expectations of behavior are enforced on every Jordan School District bus:

- 1. I will follow the driver's instructions. The driver is in charge of the bus and may assign seats.**
- 2. I will be courteous, respect property and use appropriate language.**
- 3. I will behave as expected in the classroom.**
- 4. I will not bring objects on the bus if they create a safety hazard.**
- 5. I will not eat or drink on the bus without the driver's permission.**
- 6. I will keep the bus clean.**
- 7. I will remain seated while on the bus.**
- 8. I will keep all body parts and objects inside the bus.**
- 9. I will arrive at my bus stop five minutes early and behave appropriately.**
- 10. I understand that buses are equipped with video cameras and I may be subject to video monitoring.**

WARNING: IT IS UNLAWFUL TO:

- Enter a school bus with the intent to commit a crime**
- Enter a school bus and disrupt or interfere with the driver**
- Refuse to disembark after ordered to do so (Utah Code 76-9-107)**

Students receive a bus referral from bus drivers when a student violates bus rules. An administrator meets with a student when a referral is submitted. Repeated violations will result in more serious disciplinary actions. The following consequences may occur if there are repeated violations:

First Referral:	May result in appropriate consequences, and possible probation.
Second Referral:	May result in a bus suspension and a parent conference.
Third Referral:	May result in a five-day bus suspension with riding privileges restored only after a conference including an administrator, parent, student & bus driver.
Fourth Referral:	May result in a ten-day bus suspension with the possibility of permanent removal from the bus. Another conference will be required.
Fifth Referral:	May result in permanent removal from the bus.

For questions and concerns regarding assigned buses, routes, pick-up, drop-off or other busing related issues please contact Transportation directly at 801-567-8814.

7th Grade Orientation Day



All 7th-grade students are invited to Orientation Day on August 22, 2013. School starts at 7:50 am (regular time). School will end at 12:05 pm. If you take a bus, it will pick you up at the regular time and take you home at the end of the

day. Parents are invited to attend the Back-To-School Night on August 29th.

While at school this day 7th grade students will have the opportunity to:



- Meet all of their teachers and go to all of their classes.
- Learn how to open and close their hall lockers.
- Meet their classmates and begin to build new friendships.
- Learn about Sunset Ridge Middle School and where to go for information.
- Ask questions about anything that they do not understand about middle school.
- Learn about some ways that each student may participate in building a positive environment at Sunset Ridge Middle School.
- Go to the cafeteria and see how to enter their lunch numbers.
- Begin a new school year in a positive, safe and friendly environment.



BACK-TO-SCHOOL NIGHT

Back-to-School Night is scheduled for Thursday August 29, 2013 from 4:00 pm to 6:00 pm. Take advantage of the chance to:



- Come on in and meet your student's teachers, counselors, and administrators in a positive, family-friendly environment.



- Let us tell you about our programs to boost your student's achievement.
- Learn how you can become a positive part of the school culture and make a great impact on how we work together for the betterment of every student, everyday.
- Enjoy a hotdog cooked up personally by the school administration.

You won't want to miss what will be a great kick-off to an exciting new school year! We look forward to meeting you and answering any questions that you may have.

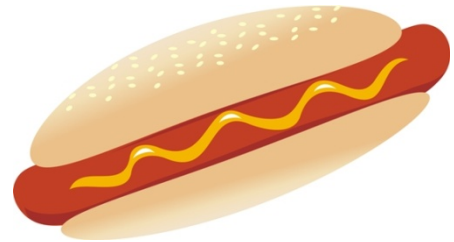

The PTSA will also be holding their general session from 5:30 p.m. to 6:00 p.m. in the auditorium. We hope to see you there.



iFLIGHT

Dear Parents and Guardians,

Sunset Ridge Middle School is continually striving to find ways to help students be successful. We will continue **iFLIGHT**—a time for students to get the extra instruction they need to be successful in school.

What is iFLIGHT?

iFLIGHT is a directed and structured time providing opportunity for students to be successful and receive additional help from their teachers. iFLIGHT is after 2nd period for up to three days a week. This time provides an opportunity for students to go to their classes where they may be struggling and not yet proficient on a standard taught. Ideally, iFlight is a school-wide intervention time where students receive additional instruction for concepts not yet understood.

How does it work?

For up to three days a week (except the last and first week of the quarter) students will be given a printout of their grades during second period. Students who have D's or F's or I's will go to iFLIGHT, which means they will go to a class in which they have a D, F, or I to work on mastery, to get help on assignments, make up work, or take a missed quiz/test. An "I" on a student's printout indicates that the student has not yet demonstrated proficiency on a major concept.

Students who have A's, B's, and C's will have the opportunity to go to an activity or to go to one of their teacher's classroom for additional help on their assignments or participate in "stretch" activities.

If a student has an "I" it is expected they will go to that classroom first to work on mastery skills. Teachers will direct students to that class first. It is expected that students will attend core classes first.

To increase instructional effectiveness teachers may close their classroom when 20 or more students attend. Therefore, it is essential that students quickly go to iFLIGHT classes to ensure they get assistance they need.

What do I need to do?

As a parent or guardian, we need your support.

- Help your student identify in which classes he or she could use extra help.
- Encourage your student to take advantage of iFLIGHT to work on mastery, get help on assignments or make up a test.
- Discuss with your student what they did during iFLIGHT.
- Show support for FLIGHT time by not checking your student out of school during this time.

iFlight

Student Procedures

*Students receive
grade printout*

**Highlight on
Printout (D,F,I)**

No Highlight
on Printout

Student chooses up to
3 INTERVENTIONS
focusing on classes
with I (then D,F)

**Student chooses up to
3 ACTIVITIES or
Interventions**

**Students go to
first choice...
if full - go to
second &
third choice
or overflow**

**All Students in
iFLIGHT
before tardy
bell rings**

**Students go
to first choice...
if full - go to
second &
third choice
or overflow**



Teacher Advisory (TA)

Teacher advisory is a student support class held on Monday throughout the year. At certain times of the year, students will report to Teacher Advisory on Thursday. During these 30 minutes the following activities may occur: school business, DEAR (Drop Everything And Read) & Study Hall, lessons related to character education, goal setting and life-long learning, and preparation for Student Led Conferences. Teachers also conduct grade checks with individual students and provide supervised study time. Students will be participating in a variety of activities and assignments and will receive a Pass/Fail grade. TA appears on each students schedule as their 8th period class.

Student-Led Conferences

Student Led Conferences is an opportunity for students to take responsibility for their education and demonstrate to their parents how they are doing in school. Student Led Conferences occur twice per year. Fall Student Led Conferences will be held on October 2-3, 2013. Spring Student Led Conferences will be held on March 5-6, 2014. Parents and students attend conferences together so they can communicate with each other and with teachers about the students' educational performance and possible areas of improvement. Together they review the students' portfolio, goals the student has developed and review grade printouts to gain an overall picture of their student's progress. Students are there to represent themselves and explain to both their parents and teachers areas in which they excel and identify any areas of concern they may have. This format provides a collaborative environment for the student, parent and teacher to discuss student strengths and areas of concern while developing a plan for continued progress.

In this section you should divide your walking map into sections or zones and then provide a written description of the path students should take to walk to school. This description should accompany the visual map.

Sunset Ridge Middle School Safe Walking Routes 2013-2014

We encourage students who walk to use the safe walking routes established by the Safe Walking Route Committee. Parents are encouraged to assist students in implementing the guidelines outlined below and in the attached maps. Parents who drive their students to the school should use the student drop-off zones on the east side of the building. Students who qualify for bussing should take advantage of these services. There is no safe walking route to the school for students who are eligible to ride the bus. We therefore strongly discourage students who qualify for bussing from walking unsafe routes. The areas below are neighborhoods within two miles of Sunset Ridge Middle School.

Area 1: "The Oaks" (located between 8200 S. & 8600 S. and Hwy U-111 & 6000 W.)

Students who live in "The Oaks" should access the roads within the neighborhoods to limit their interaction with traffic. All students who live in "The Oaks" should use 8305 S. to enter school property. Also, students who live east of 6700 W. should use Sierra Oaks Drive or Hilltop Oak Drive. Additionally, students who live east of 6400 W. should use Fall Oak Dr.

Area 2: "The Maples" (located between 7400 S. & 7800 S. and Hwy U-111 and 6400 W.)

From your home, take the shortest distance within your subdivision that safely provides access to 6700 W. At 7800 S., follow the instructions of the crossing guards to cross the street. Staying on the west side of 6700 W., travel south to 8200 S. Using the crosswalk, travel to the south side of 8200 S. Walk west to the school, using the sidewalk.

Area 3: "The Sycamores" (located west of Highway U-111 between 8200 S. and 7800 S.)

From your house, walk south to 8200 S. Use the sidewalk and stay on the north side of 8200 S. as you walk east to Highway U-111. At U-111, use the crosswalk to cross to the south side of 8200 S. Cross the intersection of Highway U-111 by accessing the sky bridge that extends over the highway. Once over the sky bridge, continue using the sidewalk to walk east to Sunset Ridge Middle School.

Area 4: "Serengeti Apartments" (located west of Highway U-111 between 6700 W. and 7800 S.)

Staying on the west side of 6700 W., travel south to 8200 S. Using the crosswalk, travel to the south side of 8200 S. Walk west to the school, using the sidewalk.

Loading/Unloading Access Zones

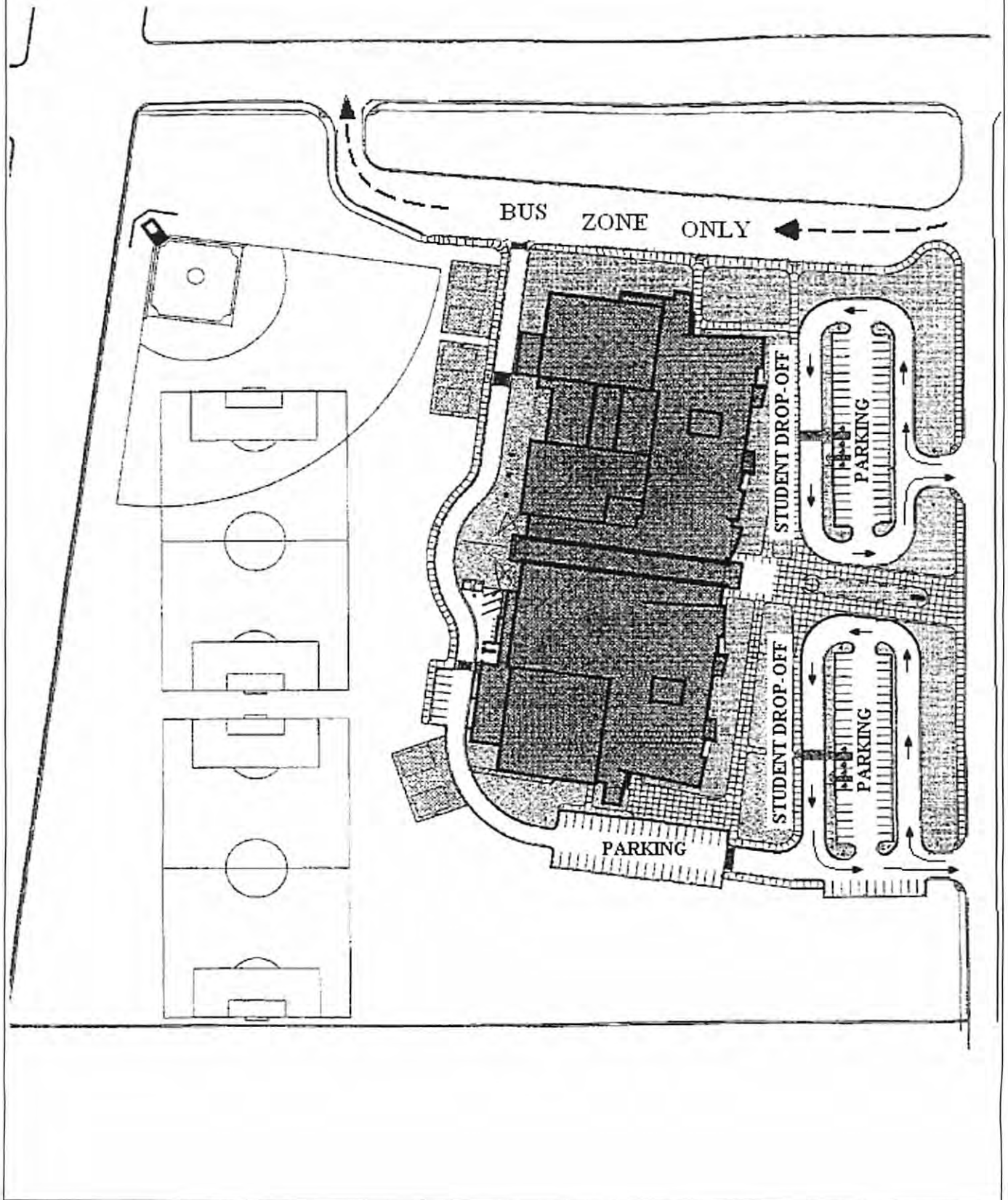

Walking Route Map

Sunset Ridge Middle 8292 South Skyline Arch Drive West Jordan, Utah 84081

For help please contact Assistant Principal at 801-412-2475 or at travis.hamblin@jordan.k12.ut.us

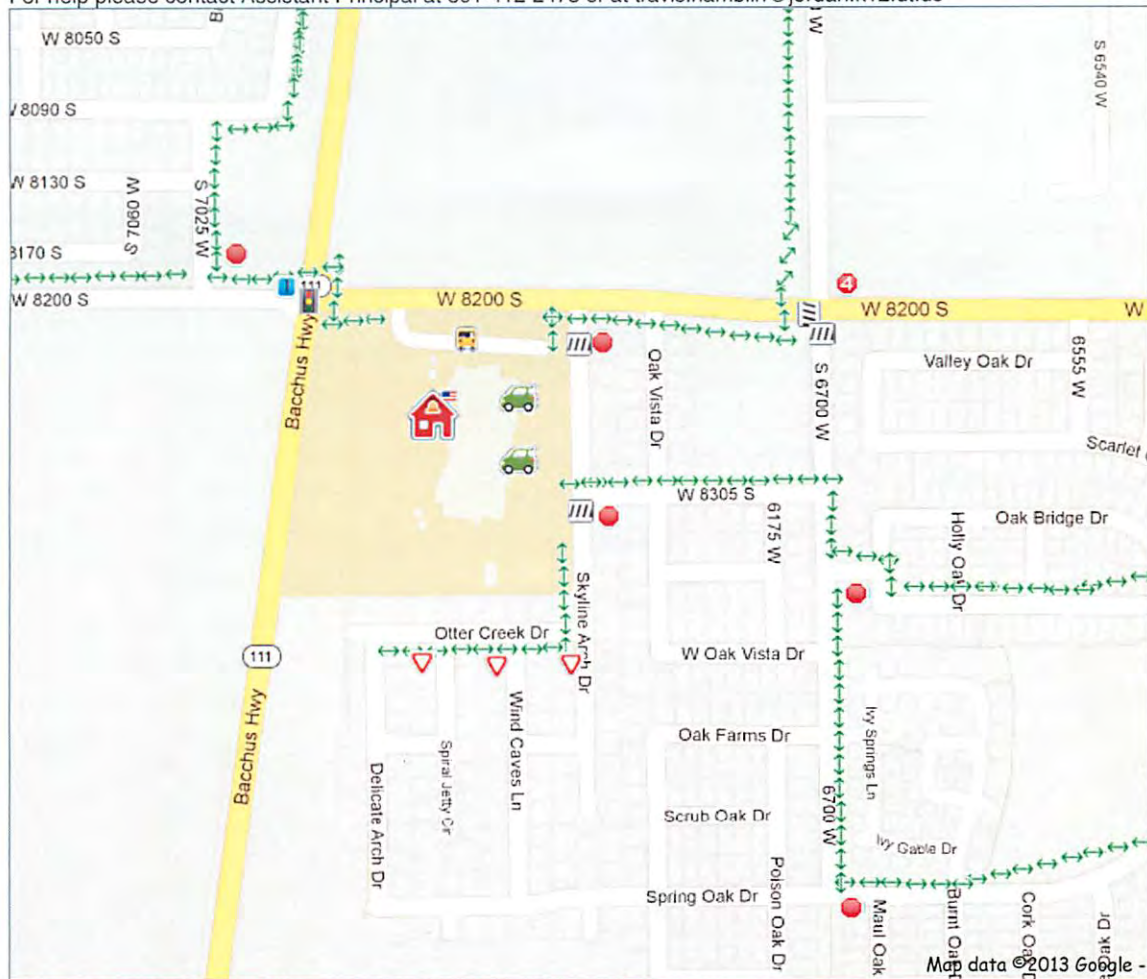

Notes: Footnote #1 identifies a pedestrian bridge that crosses U-111.

Para ver esta página en [English](#) - [Español](#)

Print Size: (8.5" x 11" - 11" x 17")

Route Key

Other	Safest Walking Route
-------	----------------------

Icon Key

School	Crossing Guard
Crosswalk-Horizontal	Crosswalk-Vertical
Traffic Signal	Stop Sign
Four-way Stop Sign	Yield Sign
School Bus Loading	Footnote 1
Student Drop-off/Pick-up	

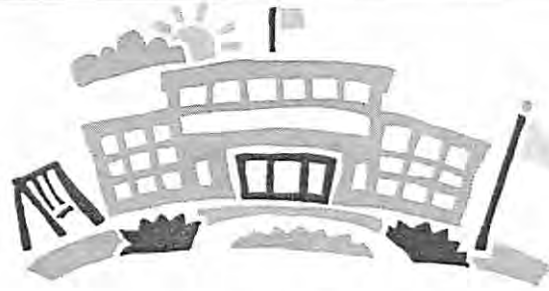

Immunization Requirements 7th Grade Entry 2013-2014

To attend the 7th grade, a student *must have* written proof of receiving the following immunizations:

- **5 DTaP/DT** (4 doses of DTaP, if 4th dose given on/after the 4th birthday; 3 doses of Td, if starting series after age 7 years with a single dose of Tdap preferred as the first dose)
- **Tdap booster *** (Regardless of interval since the last tetanus/diphtheria containing vaccine)
- **4 Polio**** (3 doses, if 3rd dose was given on/after the 4th birthday)
- **2 Measles, Mumps, Rubella**
- **3 Hepatitis B**
- **2 Hepatitis A**
- **1 Varicella (chickenpox)** – history of disease is acceptable, a parent must sign the verification statement on the school immunization record.

*Effective July 1, 2011, students entering 7th grade must have a single dose of Tdap, regardless of interval since the last tetanus/diphtheria containing vaccine.

** The final dose of polio vaccine administered ON or AFTER August 7, 2009 must be given at a minimum age of 4 years AND a minimum interval of 6 months following the previous dose. The final dose of polio administered PRIOR to August 7, 2009 will fall under the previous recommendation with a minimum interval of 4 weeks between doses.

With the exception of Tdap, a child may be allowed to attend school “conditionally” if at least one dose of each *required* immunization has been completed and the child is currently on schedule to receive the remaining immunizations. The remaining immunizations must be completed on schedule for the child to remain in attendance.

An appropriate Utah Department of Health Exemption form must be completed for children who claim an exemption to immunization for medical, religious, or personal reasons.

For questions regarding your child’s immunization status, contact your child’s health care provider, your local health department or the Immunization Hotline 1-800-275-0659.

This may be copied and distributed.
Rev 01/2013

